



**C2R2 MAX**

Version 02 – 02 April 2009

**C71**

**TRANSMISSIONS**



**C2R2MAX**

Version 02 – 02 April 2009

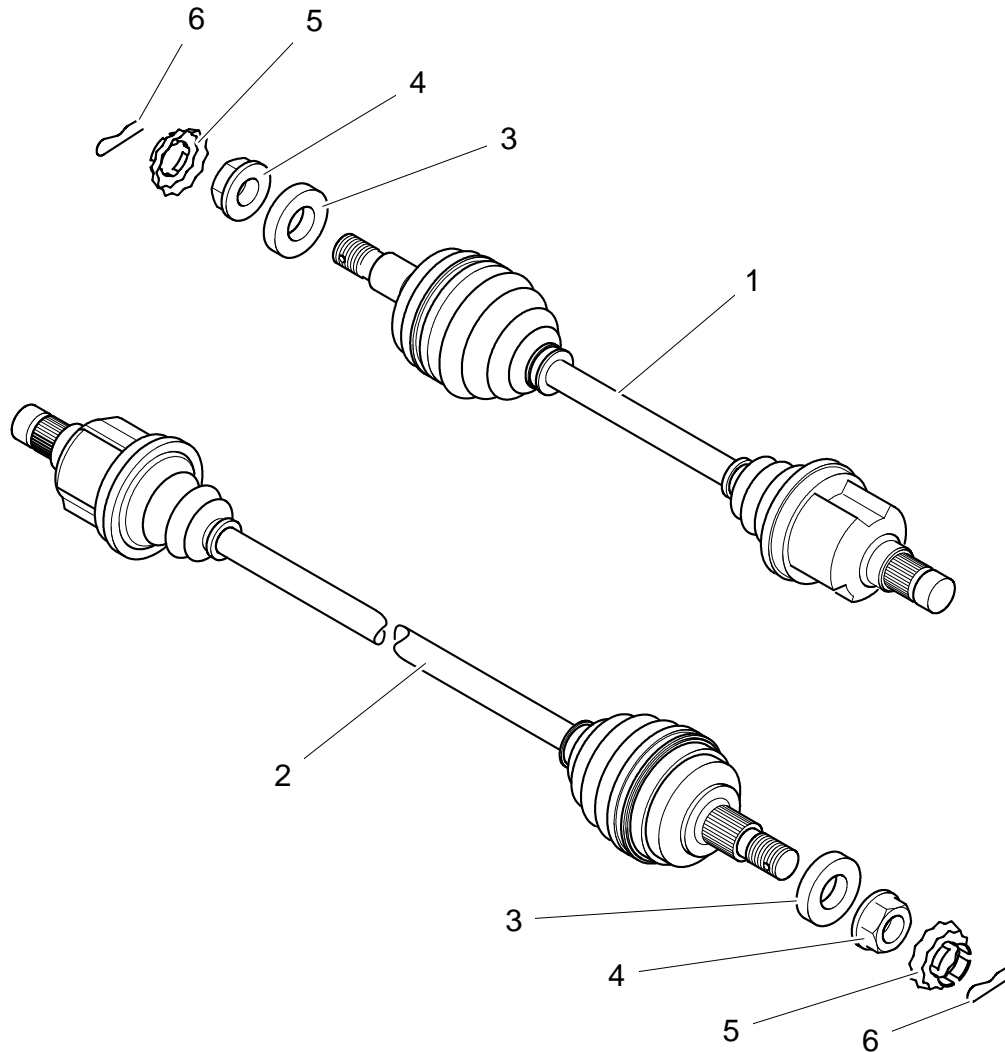

*\* Serial EVO1 Front hub has to be imperatively assembly with Left and Right driveshafts EVO1 ref 1C7163340A and ref 1C7163341A (transmission notice sheet, rev3)*

Ref	Part number	Qty	Description
1	1C7161438C	1	Right driveshaft
2	1C7161439C	1	Left driveshaft
3	BCSP329715	2	Washer, thickness 10mm
4	BCSP329733	2	Transmission screw
5	BCSP329702	2	Lock washer
6	BCSP329703	2	Pin
1A	1C7163340A	1	* EVO1Right driveshaft for standard front hub upgrade.
2A	1C7163341A	1	* EVO1Left driveshaft for standard front hub upgrade.





Apply copper grease on the threads and the grooves (wheel side only) of the drive shafts.



Copper grease



Tighten the transmissions (! do not forget the washer ref. 3 !).



**Use a torque wrench in good conditions, checked and inspected.**

24 m.kg

**C71**  
**Transmissions**



**C**  
**TRANSMISSIONS**



Assemble the retainer ([ref.5](#)) with its pin ([ref.6](#)).

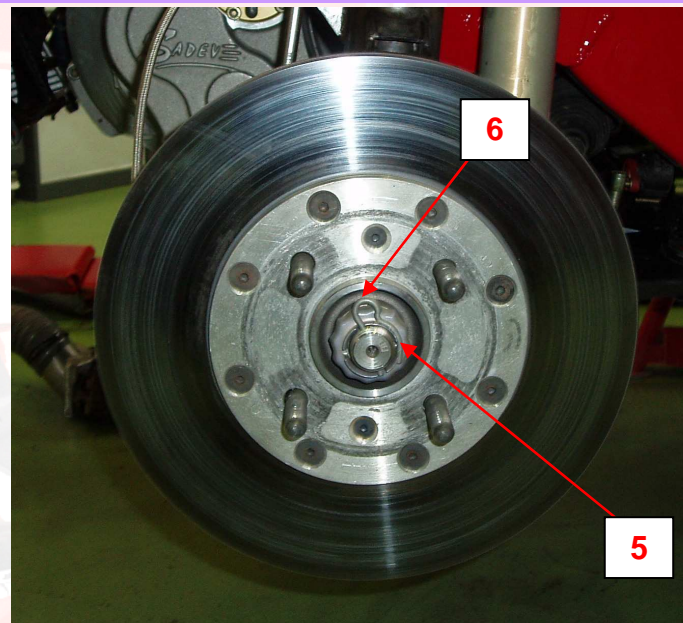

**NOTA : Check the preload (24 m.kg) of both driveshafts every 100 kms maxi of test / special stages, on services as in the workshop.**



**NOTA :** The assembly of EVO1 driveshafts is the same as the one described upper, except the nut ref3 (cancelled, as described on the drawing below).

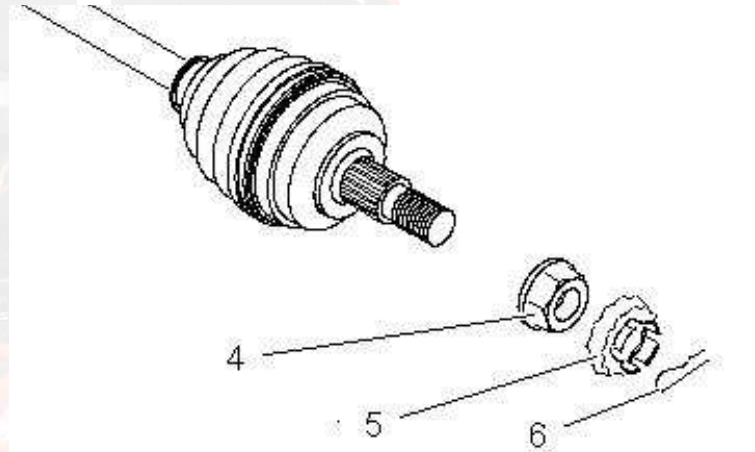

### Running-in the transmissions:

#### Step 1:

Vehicle on jack stands.

Stabilised engine speed: 3000 rpm.

Gear engaged: 5<sup>th</sup>

Cycle length: 5 min.

#### Step 2:

Proceed in the same way as step 1, steering the wheels to the left (max. angle 180°, i.e. one half- turn of the steering wheel) for 5 secs. Return to angle 0, then point to the right (identical maximum angle) during 5 secs.

Alternate the left / right steering throughout the step.

Length of the step: 5 min

#### Step 3:

Proceed in the same way as step 2, increasing the steering angle to 360° (i.e. a complete turn of the steering wheel).

Length of the step: 5 min

#### Step 4:

Finish by a debugging on road over a distance of about 10 km, avoiding using maximum steering lock.